

KRDF-D Rectangular Duct Fan

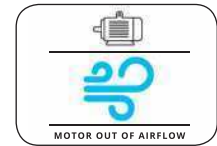

Description :

KRDF-D is used for supplying rectangular ventilation ducts with fresh air or for exhaust evacuation in the range of minimum 1100m³ / h and maximum 9800m³ / h air flow. Inspection hatch allows cleaning fan and maintenance. Motor is located out of the air flow and is not effected by matters in the air. Factory, Hospital, Office, Laboratory, Shopping Mall (shopping malls), Cafe, Commercial kitchens, Parking lots etc. It is suitable for use in all buildings with rectangular duct system.

MOTOR PROTECTION CLASS	IP 55
MOTOR INSULATION CLASS	F CLASS
MOTOR EFFICIENCY CLASS	IE2-IE3
MOTOR BRAND	GAMAK-VOLT-WAT
MOTOR ENCLOSURE TYPE	TEFC
BODY MATERIAL	GALVANIZED SHEET METAL
BODY COATING	NONE
IMPELLER TYPE	BACKWARD CURVED
IMPELLER MATERIAL	ALUMINIUM - GALVANIZED SHEET METAL
DUTY CYCLE	IEC Duty Cycle-S1
WORKING AMBIENT TEMP	-20 - +50 °C
DIRECTIVE	IEC-60335-2-80, ISO 1940-1



TECHNICAL SPECIFICATIONS AND DRAWING

MODEL	VOLTAGE (V)	FREQUENCY (Hz)	POWER (KW)	REV. (RPM)	FLOW RATE (m ³ /h)	SOUND PRESSURE dB(A) 3m	WEIGHT (KG)
KRDF-D 280	380	50	0,18	1.450	1.100	70	28
KRDF-D 315	380	50	0,25	1.600	1.469	73	32
KRDF-D 355	380	50	0,37	1.471	2.300	75	34
KRDF-D 400	380	50	0,55	1.478	3.300	78	38
KRDF-D 450	380	50	0,75	1.454	5.000	70	49
KRDF-D 500	380	50	1,10	1.462	7.000	83	63
KRDF-D 560	380	50	1,50	1.464	9.800	83	74

Values are for 0 Pa

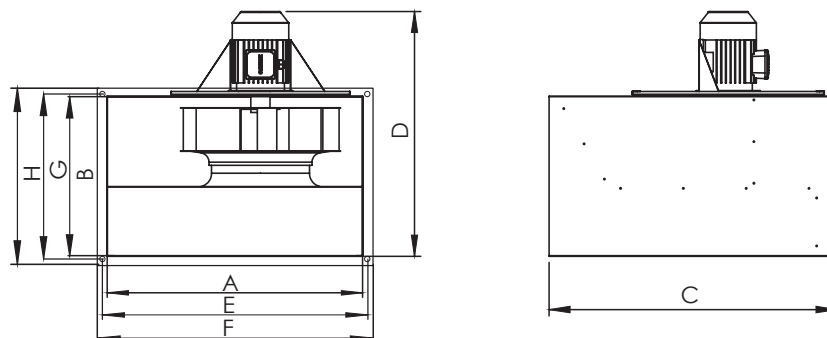

MODEL	A (mm)	B (mm)	C (mm)	D (mm)	E (mm)	F (mm)	G (mm)	H (mm)
KRDF-D 280	500	250	565	450	525	300	590	500
KRDF-D 315	500	250	565	476	525	300	590	526
KRDF-D 355	600	300	760	526	625	350	785	576
KRDF-D 400	600	350	750	590	625	400	775	640
KRDF-D 450	700	400	790	641	725	450	815	691
KRDF-D 500	800	500	900	765	825	550	925	815
KRDF-D 560	1000	500	1050	790	1025	550	1075	840

KRDF-D Performance Curves

KRDF-D 280

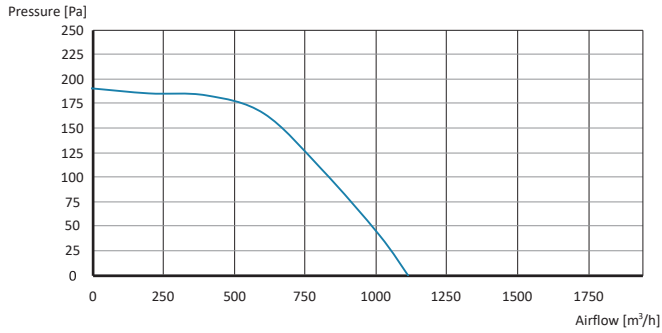

KRDF-D 315

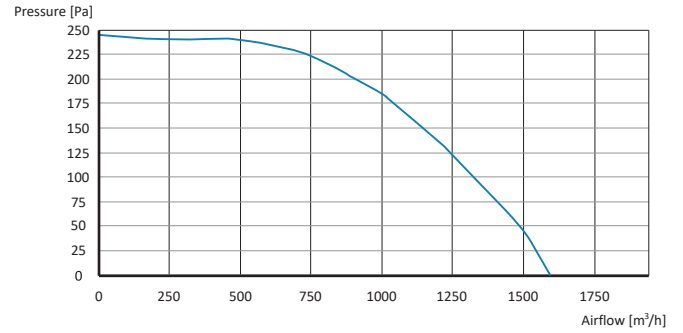

KRDF-D 355

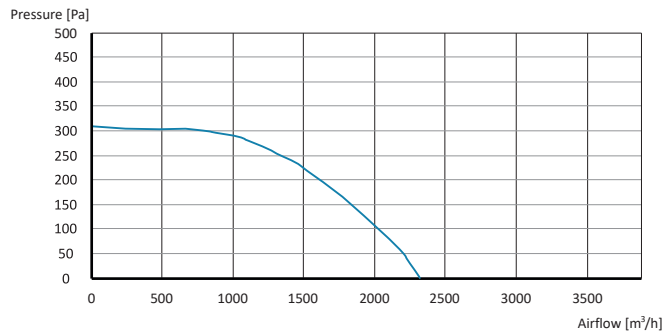

KRDF-D 400

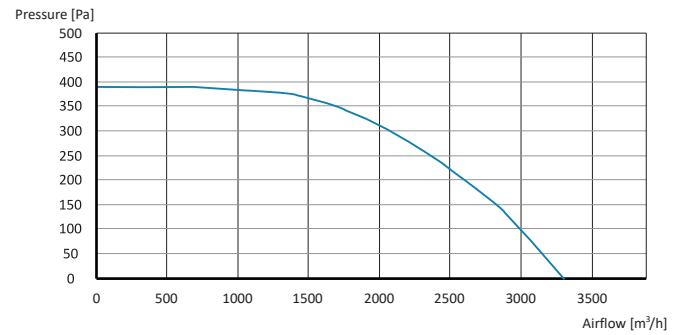

KRDF-D 450

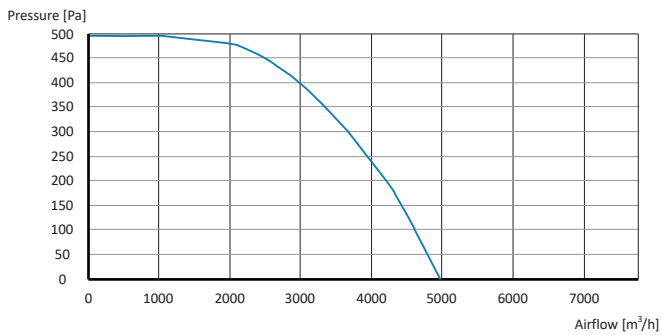

KRDF-D 500

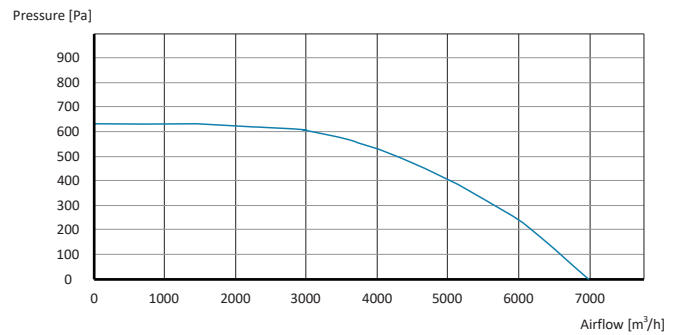

KRDF-D 560

